

**1.1**

	HDA-P/PF/PR		TE-Y (SDS max)
	HDA-P/PF/PR M16x190/40		TE-Y-HDA-B 30x190
	HDA-P/PF/PR M16x190/60		TE-Y-HDA-B 30x190

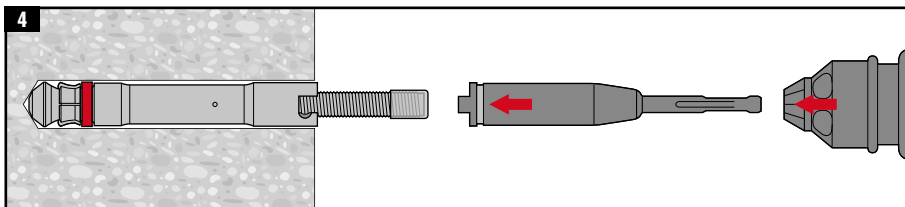
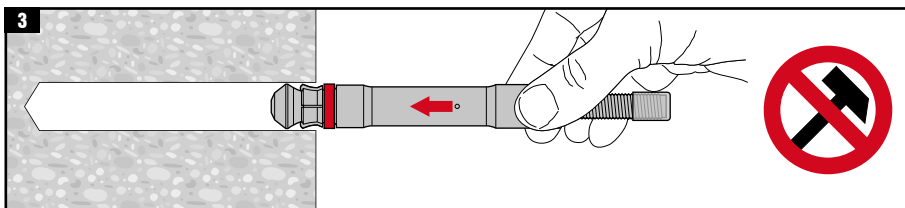
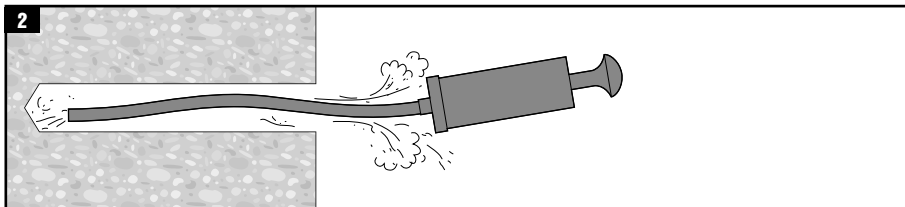

	HDA-P/PF/PR		TE-Y (SDS max)
	HDA-P/PF/PR M16		TE 70, TE 75, TE 76, TE 80

**4.2**

	HDA-P/PF/PR		TE-Y (SDS max)
	HDA-T/TF/TR M16		TE-Y-HDA-ST30-M16

**5**

	$t_{setting}$
TE 70	15 ... 30 sec (max. 60 sec)
TE 75	20 ... 40 sec (max. 60 sec)
TE 76	20 ... 40 sec (max. 60 sec)
TE 80	15 ... 30 sec (max 60 sec)

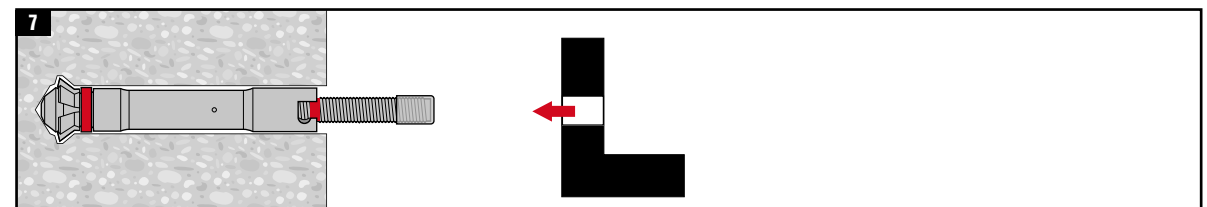
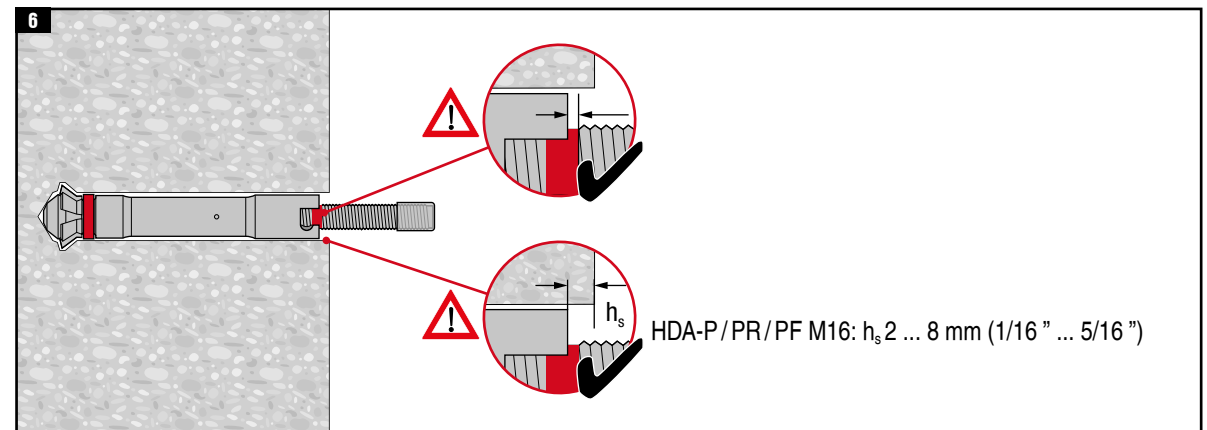

**8**

	HDA-P/PR/PF	SW		$T_{inst}$
	HDA-P/PR/PF M16	24		120 Nm (89 ft-lb)